

## CF-V-Fixx-System – Pre-Wall Installation for Cavity Walls.

The Klima Konform CF-**V-Fixx** system was specifically developed for the simple and cost-effective installation of windows and doors in the insulation plane of existing cavity walls (renovation) and in confined spaces.

The CF-**V-Fixx** profiles mounted on the building envelope form a continuous, highly thermally insulating frame, thereby improving the overall thermal performance of the connection, even with thick façade insulation.

Window installation is carried out using the CF-**V-Fixx** system panel, drilling template, and appropriate window frame screws. Connection joints can be flexibly adapted to the specific construction situation and requirements.

The system safely transfers wind and operational loads to the load-bearing structure. The profiles are bonded and additionally mechanically fastened. Test reports on system safety are available from MPA Braunschweig.

The CF-**V-Fixx** system was developed with sustainable construction in mind and also facilitates future window replacements.



Find further information on our website under pre-wall installation.



### No Thermal Bridges – No Condensation.

- Excellent thermal insulation, high load-bearing capacity
- Moisture- and frost-resistant – no swelling or shrinking
- Long-term dimensional and strength stability
- Lightweight – easy to handle
- Resistant to aging, rot, and decay
- Easily adjustable on site
- Workable with standard tools
- Offcuts can be reused
- Can also be retrofitted
- Suitable for new construction and renovation
- Flexible planning and individually adaptable
- Multiple system variants
- Material- and cost-optimized



## Dimensions and Cutting.

Determine projection depth:  
Clear cavity width minus 10–20 mm

Cutting the CF-**V-Fixx** profiles:  
Finished width = clear width plus 160 mm (80 mm on each side)  
Finished height = clear height

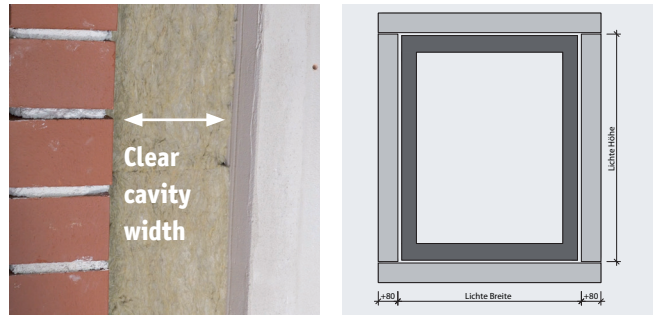

## Installation of the Profiles.

System Panel

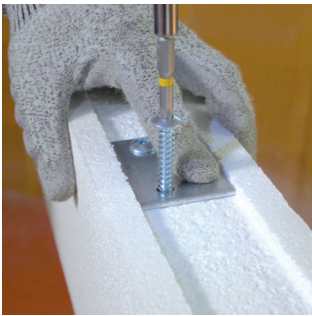

Drilling Template

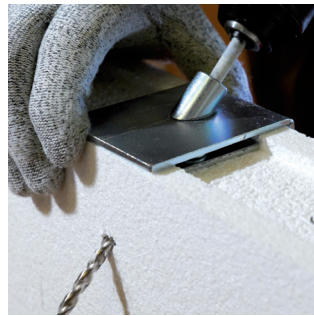

System Adhesive



Aligning



Drilling



Screwing



Mark the fixing points for the CF-**V-Fixx** system panels, starting approx. 200 mm from each profile end. The maximum distance to the next anchor point is 700 mm.

Insert the CF-**V-Fixx** system panel into the profile recess at the fixing point and secure with two window frame screws (7.5 × 62 mm). Install the remaining system panels at all fixing points in the same way. Place the CF-**V-Fixx** drilling template on the system panel and pre-drill the CF-**V-Fixx** profile through the elongated hole of the system panel.

Apply hybrid mounting adhesive to both flanges of the Klima Konform profile and position the profile on the masonry. If necessary, fix with WinBag or clamps. Align the CF-**V-Fixx** profile, ensuring a lateral overhang of 80 mm.

Drill into the backing masonry through the pre-drilled channel, observing the recommended drilling depth. Screw in the window frame screw with a countersunk head until the screw head rests against the mounting plate. Repeat this process for all fixing points, then remove WinBag or clamps if used.

At the joint surfaces of the CF-**V-Fixx** profiles, ensure three-sided bonding (backing masonry – interior – facing brick).

## Item list standard profiles and accessories.

### Standard Profiles (Length 2250 mm)

- CF-**V-Fixx** Mounting Profile 60x80 mm
- CF-**V-Fixx** Mounting Profile 80x80mm
- CF-**V-Fixx** Mounting Profile 100x80mm
- CF-**V-Fixx** Mounting Profile 120x80mm
- CF-**V-Fixx** Mounting Profile 140x80mm
- CF-**V-Fixx** Mounting Profile 160x80mm
- CF-**V-Fixx** Mounting Profile 180x80mm
- CF-**V-Fixx** Mounting Profile 200x80mm

### Adhesive

- CF System Adhesive 600ml
- CF System Adhesive 290ml

### Accessories

- CF System panel
- CF Drilling template
- CF Mounting Screw T30 7,5x62mm FK
- CF Mounting Screw T30 7,5x62mm SK
- CF Mounting Screw T30 7,5x122mm SK
- CF Mounting Screw T30 7,5x152mm SK

### Drill Bits

- SDS Plus Hammer Drill 4S DM 6mm, total length 310mm
- SDS Plus Hammer Drill 4S DM 6,5mm, total length 310mm
- SDS Plus Hammer Drill 4S DM 6mm, total length 260mm
- SDS Plus Hammer Drill 4S DM 6,5mm, total length 260mm
- MultiCon Multipurpose Drill, DM 5mm, total length 400mm
- MultiCon Multipurpose Drill, DM 6mm, total length 400mm
- MultiCon Multipurpose Drill, DM 5mm, total length 250mm
- MultiCon Multipurpose Drill, DM 5mm, total length 350mm

### Saw Blades

- Stehle ZFL Circular Saw Blade 250x3,2/2,2x30 Z=18
- Stehle ZFL Circular Saw Blade 300x3,2/2,2x30 Z=14
- Stehle ZFL Circular Saw Blade 350x3,5/2,5x30 Z=16
- Stehle ZFL Circular Saw Blade 400x3,5/2,5x30 Z=18
- Stehle ZFL Circular Saw Blade 450x3,8/2,8x30 Z=32
- Bosch Speedline Wood Circular Saw Blade 160x20 2,2/1,6, Z=18
- Bosch Speedline Wood Circular Saw Blade 165x20 1,7/1,2, Z=12

	Pallet	Item number
	230	3597
	150	3598
	180	3591
	102	3592
	102	3593
	85	3594
	72	3595
	72	3596
	VE	
	12	3634
	12	3633
	Quantity	
	1	
	1	
		1712
	1 each	2000
	1 each	2001
	1 each	2002
	1 each	2003
	1 each	2088
	1 each	2816
	1 each	2818
	1 each	2819
	1 each	1984
	1 each	1462
	1 each	2856
	1 each	1456
	1 each	2857
	1 each	1910
	1 each	1911

## The installation variant for cavity wall construction and ventilated façades.

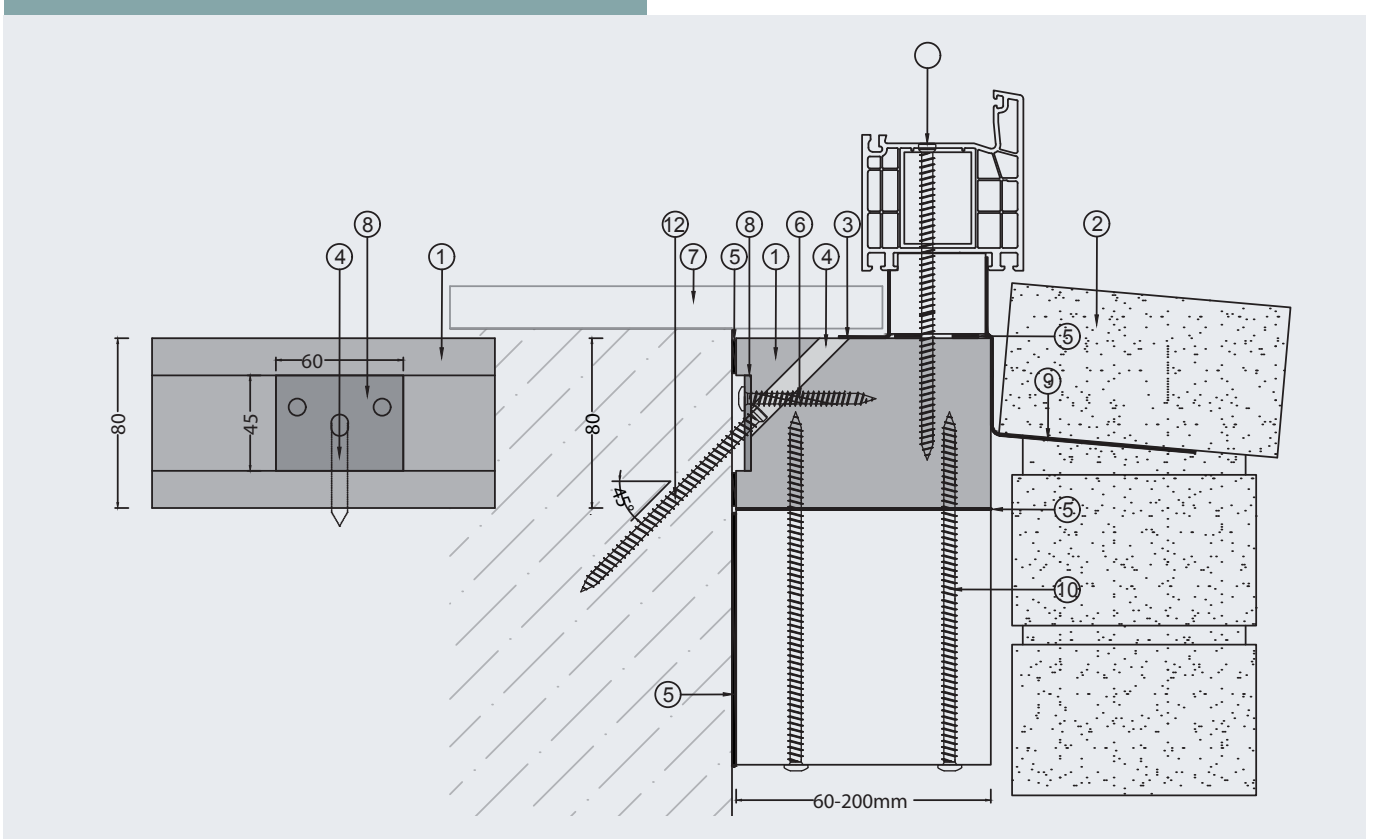

1. CF-V-Fixx Mounting Profile
2. Facing Brickwork
3. Interior Sealing Membrane
4. Drill Channel for Angled Screw Fixing with Drilling Template
5. Adhesive Beads with CF System Adhesive – 2 beads, 10 mm wide
6. CF Mounting Screw 7.5 × 62 mm
7. Interior Window Sill
8. CF-V-Fixx System Panel
9. Exterior Sealing Membrane
10. CF Mounting Screw FK 7.5 mm – length as required
11. CF Mounting Screw ZK 7.5 mm – length as required
12. CF Mounting Screw SK 7.5 mm – length as required

